

Low Cost Resistor Assemblies

These economical and powerful components comprise two, three or four high power resistors housed in partial steel covers at each end. These rugged, powder coated covers ensure an excellent seal. The internal resistors use aluminum plates at each end instead of our standard cement molding. This innovation reduces construction time and reduces cost, at no reduction of performance. The major application of this exciting new model is high power inverter braking units.

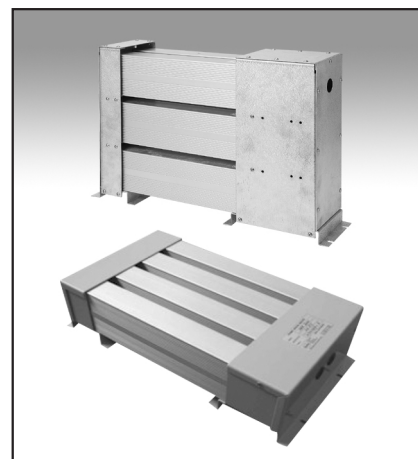

GENERAL SPECIFICATIONS

Model	Internal Resistor Type	Power Rating In Free Air [W]	Resistance Range [Ω]		Resistance Tolerance [%]
			Inductive	Non-Inductive	
LCAH 3200	IRM 1600X2	1.0k	2.3 - 160	0.6 - 46	J [±5] K [±10]
LCAH 4000	IRM 2000X2	1.2k	3.0 - 220	0.9 - 61	
LCAH 4800	IRM 2400X2	1.3k	4.0 - 280	1.0 - 74	
LCAH 5600	IRM 2800X2	1.4k	4.5 - 270	1.0 - 67	
LCAH 4800	IRM 1600X3	1.3k	0.75 - 265	0.9 - 69	
LCAH 6000	IRM 2000X3	1.4k	1.0 - 330	1.2 - 91	
LCAH 7200	IRM 2400X3	1.5k	1.5 - 420	1.5 - 111	
LCAH 8400	IRM 2800X3	1.6k	1.5 - 390	1.5 - 100	
LCAH 6400	IRM 1600X4	1.7k	0.5 - 340	1.2 - 92	
LCAH 8000	IRM 2000X4	1.9k	0.75 - 440	1.8 - 122	
LCAH 9600	IRM 2400X4	2.1k	1.0 - 560	2.0 - 148	
LCAH 11200	IRM 2800X4	2.3k	1.0 - 520	2.0 - 134	
LCAH 14000	IRM 2800X5	2.7k	0.6 - 675	2.0 - 167	
LCAV 9600	IRM 1600X6	3.0k	0.25 - 528	0.1 - 138	
LCAV 12000	IRM 2000X6	3.6k	0.33 - 678	0.1 - 183	
LCAV 14400	IRM 2400X6	3.9k	0.41 - 864	0.1 - 222	
LCAV 16800	IRM 2800X6	4.2k	0.5 - 810	0.12 - 201	

CHARACTERISTICS

Values in [] mean change in ohmic value after test

Temperature Range	-55°C ~ +275°C
Insulation Resistance	20MΩ minimum
Dielectric Withstanding Voltage	Standard: AC 1500V for 1min.; Max. leakage current : 2mA / Option : AC2000V for 1minute
Temperature Coefficient	±260ppm/°C maximum
Short Time Overload	± [2%+0.05Ω] 10 X Power rating 5 seconds
Moisture Resistance	± [3%+0.05Ω] 40°C, 95% RH, DC100V case to terminal, 500 hours
Thermal Shock	± [2%+0.05Ω] Power rating 30 minutes, -25°C, 15 minutes
Load Life	± [5%+0.05Ω] Power rating 1.5 hours on, 30 minutes off, 500 hours

DIMENSIONS [mm]

Model	Internal Resistor Type	Weight [kg]	Dimensions [mm]			
			L1±5	L2±3	W1±3	W2±3
LCAH 3200	IRM 1600X2	6.5	484	463	134	79
LCAH 4000	IRM 2000X2	7.5	554	533		
LCAH 4800	IRM 2400X2	8.5	634	613		
LCAH 5600	IRM 2800X2	10.0	704	683	204	140
LCAH 4800	IRM 1600X3	9.0	484	463		
LCAH 6000	IRM 2000X3	11.0	554	533		
LCAH 7200	IRM 2400X3	13.0	634	613		
LCAH 8400	IRM 2800X3	15.0	704	683		
LCAH 6400	IRM 1600X4	12.0	484	463		
LCAH 8000	IRM 2000X4	14.0	554	533	274	140
LCAH 9600	IRM 2400X4	16.5	634	613		
LCAH 11200	IRM 2800X4	19.0	704	683		
LCAH 14000	IRM 2800X5	24.0	704	683	339	210
LCAV 9600	IRM 1600X6	16.5	484	463		
LCAV 12000	IRM 2000X6	20.0	554	533	204	149
LCAV 14400	IRM 2400X6	23.5	634	613		
LCAV 16800	IRM 2800X6	27.5	704	683		

[LCAH]

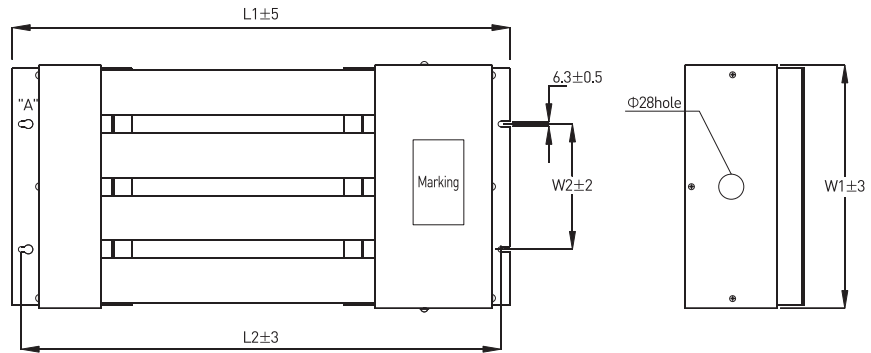
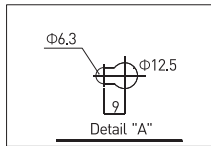

[LCAV]

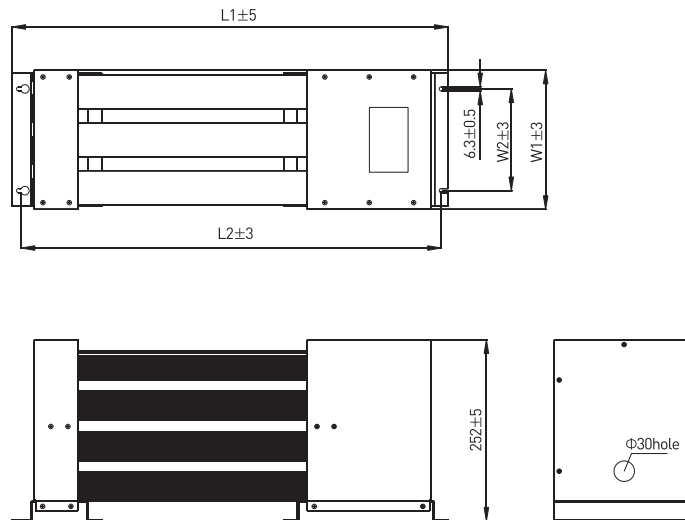

ORDERING PROCEDURE EXAMPLE

LCAH 9600

Model #

N

Non-inductive

10Ω

Resistance

J

Tolerance

Thermostat options are available for these models