

RCT RECTANGULAR THERMAL CUT-OFF RESISTOR



RCT models have a metal alloy, wire wound, ceramic core element connected to a thermal fuse. This system is housed in a thermally conductive ceramic case and then sealed and insulated with inorganic filler. These models exhibit excellent surge handling capability, high stability and quick response to overload and temperature conditions. Applications include: PDP power supplies and circuits preventing current inrush to switching regulators.

GENERAL SPECIFICATIONS

Thermal Fuse Symbol	Type of Thermal Fuse			Continuous Rated Power(W)		Resistance Range(Ω)	Resistance Tolerance (%)
	Nominal Operating Temp.(C)	Voltage Rating(V)	Current Rating(A)	05	07		
E	102	250	2	0.9	-	1-20	J(± 5) K(± 1)
K	130			1.3	-		
B	139			1.6	-		
D	150			1.8	-		
C	100	250	10	1.0	1.3		
H	121			1.3	1.7		
P	128			1.5	1.9		
B	139			1.6	2.1		
N	144			1.7	2.2		
S	152			1.8	2.3		
Q	167			2.0	2.4		

CHARACTERISTICS

Values in [] mean change in Ω after test

DC resistance	Within specified tolerance	Measure resistance at 25C
TCR	Within ± 400 ppm/C	+25C/+100C
Resistance to soldering heat	$\pm [1\% + 0.05\Omega]$	260 ± 5 C, 2-2.5mm 10 ± 1 sec. Check R 1hr at room temp
Dump heat, Steady state	$\pm [5\% + 0.1\Omega]$	25 ± 2 C, 90-95%RH, 1.5hr On/0.5hr Off cycle, 1000hr
Endurance	$\pm [5\% + 0.1\Omega]$	25 ± 2 C, 1.5hr On/0.5hr Off cycle, Rated DC V; 1Khr

ORDERING PROCEDURE EXAMPLE

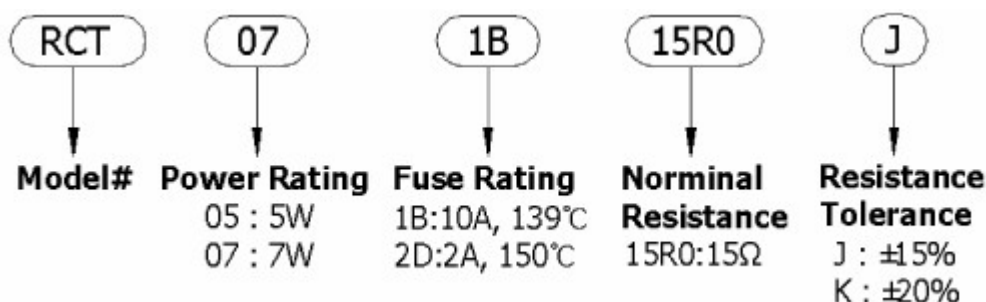

DERATING CURVES

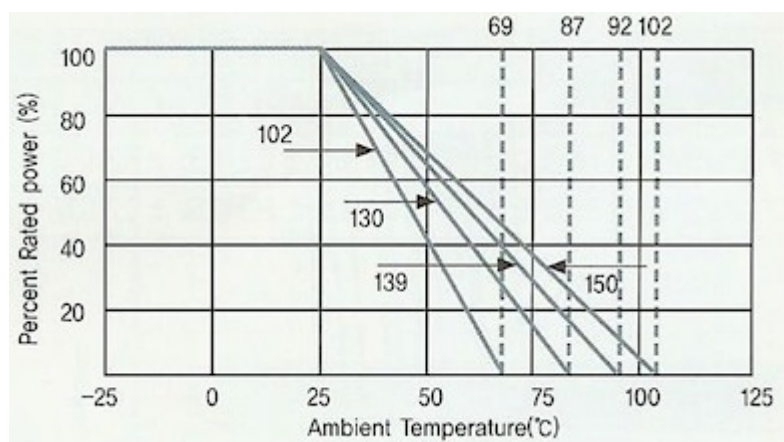
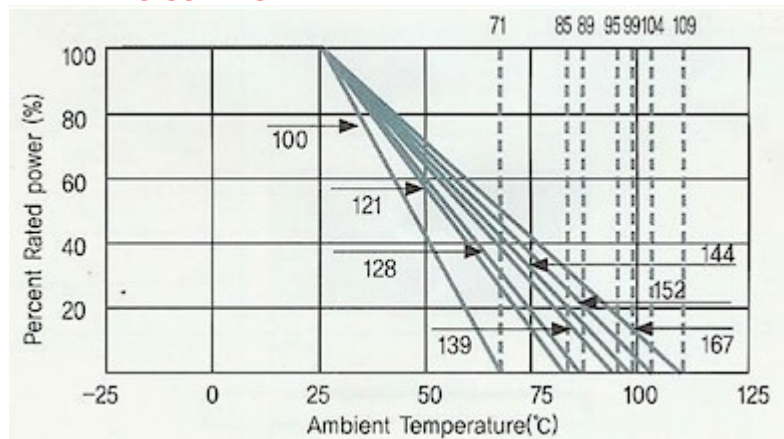

DIMENSIONS

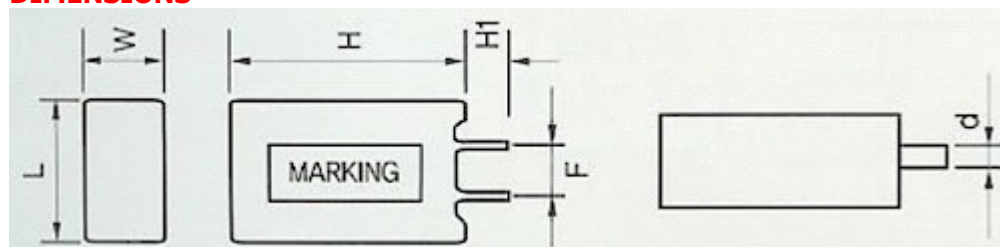

Model	Dimensions(mm)							
	L±1.0	W±1.0	H±1.5	H1±0.5	F±0.5	φd±0.02		
						Resistor	Fuse	
RCT 05	14.0	9.5	26.0	4.5	5.0	0.8	2A	0.6
							10A	1.0
RCT 07	14.0	9.5	40.0	4.5	5.0	0.8	10A	1.0